

TRAFFIC BREIF

900 County Road 6 South PROPOSED PLAN OF SUBDIVISION

PART OF NORTH HALF OF LOT 14, CONCESSION 4

TOWNSHIP OF TINY
COUNTY OF SIMCOE

August 2023

Prepared for:

West Ridge Development Corporation

Prepared by:

ConSALtech
ENGINEERING SOLUTIONS

1249 Marshall Road, Tiny, Ontario, LOK 2E1

705-722-1878

Executive Summary

This Traffic Brief has been commissioned by West Ridge Development Corporation to examine the impact of increased traffic from a proposed 14 lot residential development in the Township of Tiny.

The West Ridge Development Corporation proposal includes for the development of 14 single family residential lots and 1 hamlet commercial lot on 5.42 hectares of land situated west of County Road 6 South and south of McKenzie Street in the hamlet of Wyevale.

The proposal is estimated to generate 170 vehicle trips per day and approximately 19 trips during the PM Peak Hour.

Background traffic data for County Road 6 South has been obtained from the County of Simcoe for several years up to and including 2020. A Horizon year of 2027 has been adopted for assessment of the transportation system.

The analysis concludes that development of the site is not anticipated to result in new traffic issues or exasperate existing conditions.

TABLE OF CONTENTS

EXECUTIVE SUMMARY	I
1.0 INTRODUCTION	1
1.1 DESCRIPTION OF DEVELOPMENT PROPOSAL.....	1
1.2 STUDY AREA	1
2.0 HORIZON YEAR AND TIME PERIODS FOR ANALYSIS	3
2.1 HORIZON YEAR.....	3
2.2 PEAK PERIODS.....	3
3.0 EXISTING TRAFFIC CONDITIONS.....	3
4.0 BACKGROUND TRAFFIC GROWTH	4
4.1 DISTRIBUTION	4
5.0 ESTIMATED SITE GENERATED TRAFFIC	5
5.1 DISTRIBUTION	6
6.0 EVALUATION OF IMPACTS FROM SITE GENERATED TRAFFIC	6
6.1 COUNTY ROAD	6
6.2 INTERSECTIONS.....	6
7.0 SIGHT DISTANCE EVALUATION	8
8.0 TRANSPORTATION SYSTEM MITIGATION MEASURES	8
8.1 REQUIRED ROAD IMPROVEMENTS.....	8
8.2 REQUIRED INTERSECTION IMPROVEMENTS	8
9.0 SUMMARY AND CONCLUSIONS	8

LIST OF FIGURES AND DRAWINGS

- Figure 1: Site Location Plan
- Figure-2: Pre-Development AADT Turning Movements (2020)
- Figure-3: Pre-Development PM Peak Hour Turning Movements (2020)
- Figure-4: Post Development AADT Turning Movements (2027)
- Figure-5: Post Development PM Peak Hour Turning Movements (2027)

APPENDICES

- Appendix “A” - County of Simcoe Background Traffic Data
- Appendix “B” - Figures 2, 3, 4 & 5
- Appendix “C” - MTO Figure EA-2

Traffic Brief
Proposed Plan of Subdivision
900 County Road 6 South
TOWNSHIP OF TINY

1.0 Introduction

1.1 Description of Development Proposal

The subject development proposes the creation of 14 single family residential lots and 1 hamlet commercial lot on approximately 5.42 hectares of land situated west of County Road 6 South and south of McKenzie Street in the hamlet of Wyevale, Township of Tiny. The subject lands are legally described as Part of William Street and Part of Albert Street and Part of Firstbrook Avenue, west side of King Street, Registered Plan 327 and Part of North Half of Lot 14, Concession 4, Township of Tiny, County of Simcoe.

This report develops trip generation for the proposed 14 residential lots only. The proposed Hamlet Commercial lot fronting County Road 6 S will be subject to a site-specific analysis when a specific use for this lot is brought forward for site plan approval.

This report will be submitted to the Township of Tiny and the County of Simcoe in support of an Application for Plan of Subdivision.

1.2 Study Area

This report examines the impact of the proposed development on the leg of County Road 6 South between Tiny Concession 4 and County Road 25. A detailed evaluation of the intersection of County Road 6 South and McKenzie Street has also been completed. A site location map has been included overleaf as Figure No.1.

It is common practice to extend the area of study to include all intersections which will experience an increase of greater than 5 percent as a result of the development proposal.

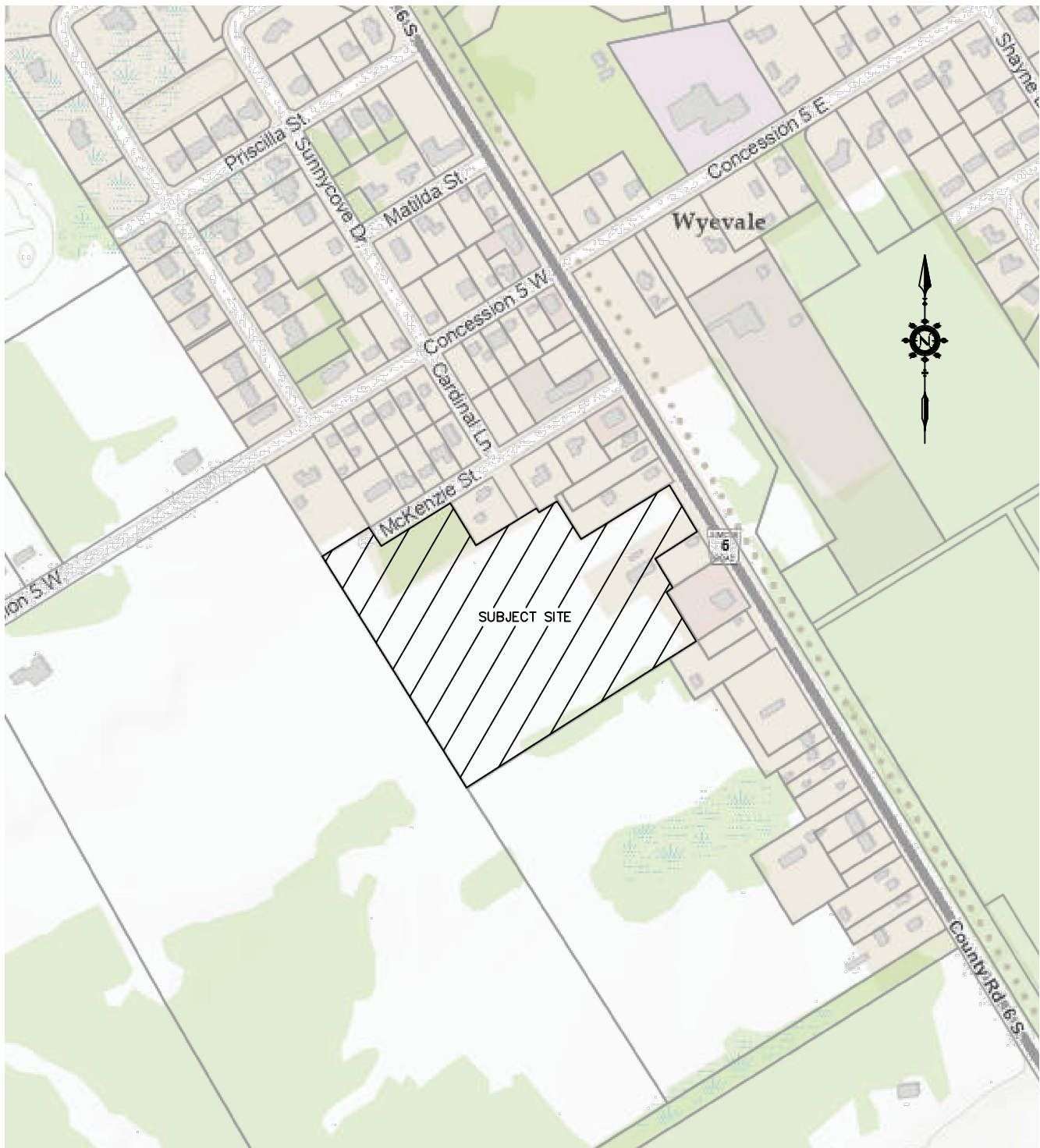

ConSALtech

Engineering Solutions

1249 Marshall Road, Tiny, Ontario, L0K 2E1
705-722-1878

SITE LOCATION PLAN

900 COUNTY ROAD 6 SOUTH

Checked		Drawn	
Date	OCT 2012	Proj. No.	
Scale	N.T.S.	Figure No.	FIGURE No.1

In the case of this proposal, the most probable location for additional assessment would be the intersection of County Road 6 South and Concession 5, however, it has been determined that this proposal will only represent an increase of approximately 2.5% and therefore an extension of the study area is not warranted.

2.0 Horizon Year and Time Periods for Analysis

2.1 Horizon Year

It is generally agreed that the horizon year for impact analysis should be 5 years from the date of development. This development was initiated in 2022 and considering that the most current available traffic data for the County Road was collected in 2020, a Horizon year of 2027 or 7 years has been adopted for evaluation. This horizon year is expected to match the final build out of the site based on current market trends.

2.2 Peak Periods

The analysis completed herein has concentrated on the Weekday PM Peak Period. The time frame is generally accepted as the “Worst Case” for residential development traffic and the transportation system background traffic.

3.0 Existing Traffic Conditions

Information regarding the existing traffic conditions for County Road 6 South adjacent to the site was obtained from the County of Simcoe by direct contact with the Roads and Engineering Department. The information gathered considers the portion or leg of County Road 6 South from Tiny Concession 4 north to County Road 25 at Perkinsfield and includes average annual daily traffic (AADT) volumes for the years 2011, 2014, 2017 and 2020 as well as more recent hourly traffic counts completed by the County in the summer and fall of 2020. The following table outlines the available information.

<u>ROAD</u>	<u>LOCATION</u>	<u>2011</u>	<u>2014</u>	<u>2017</u>	<u>2020</u>
County Road 6 S	Between Tiny Conc 4 and Cty Rd 25	4200	4400	4900	5400

The most recent information also includes a daily record of the hourly trips for the north and south lanes of the road. This information has been included in Appendix “A” and suggests a PM Peak volume of 478 vehicles per hour, 255 vph north bound and 223 vph south bound.

4.0 Background Traffic Growth

The existing traffic information outlined in the foregoing section has been analyzed to derive an appropriate growth factor. Considering the 2011 and 2020 data, an annual increase of approximately 3.17% has been derived and in turn used to develop an AADT for the Horizon year (2027) as follows:

$$2011 \text{ AADT} = 4200 \text{ vpd}$$

$$2020 \text{ AADT} = 5400 \text{ vpd}$$

$$\text{Annual increase in volume} = 3.17\%$$

$$\text{Estimated 2027 AADT} = 6718 \text{ vpd}$$

$$\text{Estimated 2027 PM Peak} = 595 \text{ vph}$$

4.1 Distribution

The traffic counts completed in 2020 included hourly volumes for both the north and south lanes of the County Road. This information is summarized below and indicates a distribution of approximately 50/50 for the average daily traffic. The PM Peak Hour, however, indicates a distribution skewed towards the north (53% north bound, 47% south bound) which would appropriately represent commuters returning home from the urban areas to south at the end of the workday.

	<u>Total</u>	<u>North Bound</u>	<u>South Bound</u>
2020 average daily traffic	5400	2700	2700
		50%	50%
2020 PM Peak Hour	478	255	223
		53%	47%

Figure No. 2 and 3, Appendix “B” has been prepared to illustrate the existing conditions for County Road 6.

5.0 Estimated Site Generated Traffic

Traffic characteristics for residential development can generally be accurately predicted by applying the formula developed by the Institute of Transportation Engineers (ITE) and outlined within the Trip Generation Manual (10th Edition). The trip generation manual develops values for trips ends versus dwelling units for various types of development. The single-family residential formulas have been used for this development. For the subject development, the site generated trips for the average day and the PM peak hour have been generated by applying the ITE fitted curve equations for each case as follows.

Average day trips (x = 14 units)

$$\text{Ln}(T) = 0.920 \text{ Ln}(x) + 2.707$$

$$T = 170 \text{ vpd}$$

PM Peak Hour (x = 21 units)

$$\text{Ln}(T) = 0.887 \text{ Ln}(x) + 0.605$$

$$T = 19 \text{ vph}$$

5.1 Distribution

The ITE also suggests directional distributions based on the results of their studies. The distributions for single family detached residential is typically split 50/50 for the average day and 64 entering/36 exiting during the PM Peak Hour. These values differ slightly from the existing 2020 data for County Road 6 South as outlined above. For the purposes of this evaluation the ITE distribution has been adopted for the site generated traffic volumes for evaluation.

Figure No. 4 and 5, Appendix “B” have been prepared to illustrate the estimated conditions for the horizon year including the additional traffic created by the development of 14 residential units.

6.0 Evaluation of Impacts from Site Generated Traffic

6.1 County Road

The preceding discussion has developed an estimated horizon year (2027) AADT of 6718 vehicles per day (vpd). Development of the subject site is estimated to add approximately 170 trips per day, thereby increasing the AADT to 6880 vpd (2.5% increase). The safe capacity of a two lane is generally considered to be 12,000 to 15,000 vehicles per day. Therefore, sufficient capacity exists to permit the development of the subject site without exceeding the safe capacity of the transportation system.

6.2 Intersections

In order to examine the existing and projected turning movements at the intersection of County Road 6 South and McKenzie Street, the existing movements must be derived. Existing traffic counts for this intersection are not available. For the purposes of this assessment, the average day trip counts and the PM Peak Hour trips has been derived by applying the ITE fitted curve equations used above to the existing dwelling units on McKenzie. Conservatively, all dwelling units on McKenzie Street have been assumed to use McKenzie Street to access County Road 6 South.

Trips utilizing Cardinal Lane as an alternative have been discounted. There are currently 11 dwelling units fronting McKenzie Street.

Based on the foregoing the estimated trips for McKenzie Street are derived as follows:

Average day trips (x = 11 units)

$$\text{Ln}(I) = 0.920 \text{ Ln}(x) + 2.707$$

$$= 136 \text{ vpd}$$

PM Peak Hour (x = 11 units)

$$\text{Ln}(I) = 0.887 \text{ Ln}(x) + 0.605$$

$$= 15 \text{ vph}$$

The existing and projected turning movements illustrated on Figures No. 2 through 5 have been analyzed using the procedures outlined in the Ministry of Transportation “Geometric Design Standards for Ontario Highways” manual. A copy of Figure EA-2 for less than 5% left turns and a design speed of 50 km/h has been reproduced from the manual and included in Appendix “D”. Figure EA-2 outlines left turning lane warrants based on the volume of advancing and opposing traffic for the design hour and a design speed of 50km.h.

The post development (2027) PM Peak Hour traffic volumes have been plotted on to Figure EA-2 for consideration.

Analysis of the estimate PM Peak Hour traffic volumes for the post development horizon year of 2027 based on the MTO’s theoretical warrants indicates that a left turning lane is not warranted based on current conditions and similarly at the Horizon year.

It is therefore reasonable to conclude that the intersection will continue to function adequately following development of the subject site.

7.0 Sight Distance Evaluation

The minimum sight distance based on the 50km/h posted speed limit for County Road is 65m. An increased distance up to 120m should be considered for left turns onto a 2-lane road and for crossing movements.

Examination of the intersection of McKenzie Street with the County Road 6 South indicates that sight distances of greater than 500m can be achieved both north and south from the existing intersection.

8.0 Transportation System Mitigation Measures

8.1 Required Road Improvements

County Road 6 South is a two-lane arterial road having a capacity of 12,000 to 15,000 vpd. The estimated AADT for the horizon year including that which will be generated by the subject development is approximately 6880 vpd. No improvements are warranted.

8.2 Required Intersection Improvements

Analysis of the intersections of the McKenzie Street with County Road 6 South indicates that the additional turning movements generated by the proposed development will not warrant the addition of a left turning lane.

9.0 Summary and Conclusions

This report has been completed to provide a comprehensive assessment of the impact of increased traffic from the proposed development of 14 single family residential lots on approximately on 5.42 hectares of land situated west of County Road 6 South and south of McKenzie Street in the hamlet of Wyevale, Township of Tiny.

The proposal is estimated to generate 170 vehicle trips per day and approximately 19 during the PM Peak Hour.

Background traffic data for the County Road has been obtained from the County for several years up to and including 2020. A Horizon year of 2027 has been adopted for assessment of the transportation to provide for build out of the site and an annual increase in the background traffic. Based on the data obtained, County Road 6 South experiences an annual traffic increase of approximately 3.17%.

Traffic volumes for the Horizon year have been estimated to be approximately 6880 vehicles per day, which falls safely within the nominally 12,000 to 15,000 vehicle per day capacity of the two-lane road.

An assessment of the PM Peak Hour turning moments suggests that the current and future estimated volumes do not warrant a left turn lane based on the MTO “Geometric Design Standards for Ontario Highways”. On this basis, the provision of a left turn lane should not be a requirement for development of the subject site.

All of which is respectfully submitted,

ConSALtech Engineering Solutions



Shayne Large, CET



Robin Smith, P.Eng.

APPENDIX “A”

Background Traffic Data County of Simcoe



**TRANSPORTATION AND
ENGINEERING**

County of Simcoe

Transportation & Engineering

Annual Average Daily Traffic Summary (A.A.D.T.)

Updated Oct 2019

<u>Road# - Section #</u>	<u>Distance</u>	<u>Link Description</u>	<u>2010</u>	<u>2011</u>	<u>2012</u>	<u>2013</u>	<u>2014</u>	<u>2015</u>	<u>2016</u>	<u>2017</u>	<u>2018</u>	<u>2019</u>
		CR 27										
001-01	6.1		4,100			3,900			4,300			4,400
		15th SR New Tecumseth										
001-02	2.0		4,700			4,400			4,700			4,800
		East Limits / Beeton										
001-03	1.9		4,500			4,400			4,600			4,500
		CR 10										
001-04	3.1		3,200			2,400			3,300			4,000
		Adj/Tos Townline										
001-04A	2.9		N/A			2,800			4,000			4,700
		CR 50										
001-05	7.2		1,900			1,900			2,400			2,200
		Simcoe Boundary										
		CR 39										
003-01	3.1		4,700			4,100			6,000			6,500
		CR 4										
		Bradford Limits										
004-01	9.8		12,500			14,800			18,400			18,000
		CR 89 / CR 3										
004-02	4.4		9,200			11,500			11,300			12,000
		Line 4 / Churchill										
004-03	5.5		9,000			10,800			11,200			11,500
		CR 21										
004-04	2.8		11,200			11,900			12,000			11,000
		Victoria St. / Stroud										
004-05	2.9		13,000			13,600			14,100			12,500
		Lockhart Dr. / Barrie Limit										
		CR 15										
005-01	4.1		4,100			4,000			4,500			4,100
		CR 13										
005-02	5.6		2,400			1,800			2,500			2,900
		County Boundary										
		CR 27 N										
006-01	5.5			4,600			4,600			5,000		
		Conc 4 / Tiny										
006-02	8.2			4,200			4,400			4,900		
		CR 25 / Perkinsfield										
006-03	1.4			4,700			5,000			4,700		
		Conc 11/ Tiny										
006-04	2.8			3,900			4,300			4,800		
		Conc 13 / Tiny										
006-05	4.1			3,200			3,600			4,300		
		CR 26										

<u>Road# - Section #</u>	<u>Distance</u>	<u>Link Description</u>	<u>2010</u>	<u>2011</u>	<u>2012</u>	<u>2013</u>	<u>2014</u>	<u>2015</u>	<u>2016</u>	<u>2017</u>	<u>2018</u>	<u>2019</u>
		Hwy 26										
007-01	4.5	Wasaga South Limit			5,500			7,500			9,500	
		CR 10										
009-01	4.3	6 / 7 SR, Creemore Ave			3,400			3,600			3,600	
009-02	3.8	Centre Line Road			2,000			2,200			2,200	
009-03	2.7	CR 42 / Cashtown Corners			2,500			2,800			3,400	
009-04	2.5	Fairgrounds Road			3,200			N/A			3,800	
009-05	6.7	Conc 8 / Clearview			850			850			1,100	
009-06	6.1	CR 124			550			600			700	
		Hwy 9										
010-01	2.7	CR 14	7,200			7,300			9,500			9,200
010-02	4.2	CR 1	6,500			6,900			8,200			6,800
010-03	8.0	Industrial Rd / 14th Conc	6,400			8,300			8,500			7,100
010-04	0.5	Honda Entrance	N/A			10,600			12,000	12,700		
010-05	2.5	Hwy 89	N/A			9,000				15,000		
010-06	9.2	CR 21	6,000			6,100			7,400			7,600
010-07	8.8	CR 90	5,200			5,500			6,700			7,000
010-08	7.3	CR 9			9,200			9,600			9,900	
010-09	10.0	Hwy 26			5,400			5,400			6,000	
010-10	4.4	Wasaga Beach Limits			3,700			3,800			5,200	
		Hwy 11										
011-01	5.3	12th Conc / Oro - Rugby		3,400			3,900			5,200		
011-02	13.1	3rd Line Oro		2,100			2,300			3,300		
011-03	5.5	CR 93		2,600			3,100			3,900		
011-04	1.0	Hwy 400		3,300			3,700			4,600		

Road# - Section #	Distance	Link Description	2010	2011	2012	2013	2014	2015	2016	2017	2018	2019
		CR 13										
012-01	3.9	County Boundary	1,300			1,400			1,700			1,900
		Hwy 89										
013-01	5.7	CR 5	2,600			2,500			3,000			3,700
013-02	9.5	CR 12	1,900			2,900			2,100			2,200
		CR 50										
014-01	3.8	Adjala-New Tech Townline	950			1,200			900			1,100
014-02	2.9	CR 10	1,700			1,700			1,700			1,900
		CR 27										
014-03	3.0	Highway 400										3,700
		Victoria St. / Alliston										
015-01A	1.1	Essa Rd	8,800			9,100			N/A			N/A
015-01	4.7	CR 5	5,600			5,200			5,200			5,200
015-02	3.5	CR 21	5,000			4,800			5,000			5,500
015-03	1.2	Base Borden South Limit	2,400			2,100			2,100			2,100
		CR 23										
016-01	6.2	Hwy 400		5,100			4,200			5,100		
		Coldwater / North Limits										
017-01	6.8	Quarry Road		1,500			1,600			1,600		
017-02	4.3	4th Conc. Silklane		1,200			750			1,100		
017-03	11.9	Big Chute		400			300			320		
		Hwy 12										
019-01	2.5	Hwy 400		1,200			1,200			1,700		
019-02	2.0	8th Conc / Moonstone		1,600			1,700			2,000		
019-03	10.8	Hwy 93		1,000			1,100			1,600		
019-04	8.1	CR 27		1,900			1,700			1,900		
		Barrie Limits										
020-01	7.4	Line 3 Oro-Medonte		3,100			2,600			2,900		
020-02	6.0	Line 7 Oro-Medonte		1,500			1,500			1,900		
020-03	6.2	Line 11 Oro-Medonte		1,000			1,000			1,200		
020-04	1.1	Line 11 / Hwy 11		1,800			1,700			2,100		

<u>Road# - Section #</u>	<u>Distance</u>	<u>Link Description</u>	<u>2010</u>	<u>2011</u>	<u>2012</u>	<u>2013</u>	<u>2014</u>	<u>2015</u>	<u>2016</u>	<u>2017</u>	<u>2018</u>	<u>2019</u>
		CR 39										
021-01	3.0		11,100			12,200			14,700			13,300
		CR 4										
021-02	3.1		11,800			11,800			13,900			13,300
		CR 54 (10th SR)										
021-03	2.2		14,000			13,700			18,300			16,600
		Hwy 400										
021-04	0.6		13,100			13,200			17,000			15,400
		5th SR Innisfil										
021-05	3.0		9,000			9,300			11,100			10,800
		CR 27										
021-06	6.4		5,700			6,000			7,400			7,000
		CR 56										
021-07	4.2		6,100			6,300			6,800			7,500
		CR10										
021-08	4.2		4,700			4,900			5,700			6,100
		CR 15										
		Hwy 12										
022-01	9.6			4,300			4,600			5,800		
		Coulson/ 7th Line										
022-02	4.9			4,300			4,600			5,100		
		Horseshoe Valley Resort Ent.										
022-03	5.2			5,500			5,300			6,800		
		CR 93										
022-04	1.4			5,800			6,300			7,100		
		Hwy 400										
022-05	4.6			5,600			6,100			7,100		
		CR 27										
022-06	2.6			4,400			4,600			5,600		
		Wilson Drive - Anten Mills										
022-07	3.9			3,900			4,100			5,100		
		CR 29										
022-08	0.5			6,200			6,400			8,200		
		Hwy 26										
		Hwy 400										
023-01	4.7			1,800			2,800			2,100		
		Gervais Rd										
023-02	5.6			1,900			2,800			2,500		
		CR 58										
023-03	5.0			1,900			2,200			2,300		
		Hwy 93										
		CR 93										
025-01	2.9				5,900			6,000			6,700	
		2nd Conc / Baseline Rd										
025-02	3.2				4,200			4,300			4,700	
		CR 6										
		Robert St / Penetang										
026-01	4.3				2,400			2,500			4,400	
		16th Conc										
026-02	3.1				2,100			2,100			2,200	
		CR 6										
026-03	3.0				2,700			2,800			3,100	
		Cedar Point Rd - 19/18 SR										

Road# - Section #	Distance	Link Description	2010	2011	2012	2013	2014	2015	2016	2017	2018	2019
		Hwy 9										
027-01	9.7		6,100			6,700			8,300			8,100
		CR 88										
027-02	11.5		4,700			5,100			6,500			5,400
		Hwy 89										
027-03	9.8		6,300			5,500			6,700			5,100
		CR 21 / North Junction										
027-04	3.1		9,400			9,800			10,500			9,500
		Essa Road										
027-05	6.8	(old Hwy 131)	10,300			10,200			12,200			11,000
		CR 90										
		Hwy 26										
027-07	7.6				11,200			10,900			11,100	
		CR 22										
027-08	11.3				10,100			10,500			11,000	
		Elmvale South Limits										
027-09	2.2				9,000			8,700			8,900	
		CR 6										
027-10	7.6				4,000			4,100			4,000	
		Hwy 93 / Wyevale										
		CR 90										
028-01	1.9			5,200			4,600			6,800		
		CR 40										
028-02	4.7			4,700			5,100			7,300		
		CR 43										
028-03	5.1			4,600			5,200			6,800		
		Hwy 26										
		CR 22										
029-01	4.1				3,900			4,400			5,200	
		Flos Road 4										
029-02	6.8				4,000			4,000			4,700	
		CR 92										
029-03	7.8				2,500			2,400			2,900	
		Conc 4/ Tiny										
		CR 34										
032-01	2.7				3,200			4,000			4,700	
		10th Concession										
032-02	1.9					2,700		3,000			4,400	
		Poplar SR										
032-03	2.6							2,900			4,400	
		CR 124										
032-04	1.5							9,600			10,200	
		Raglan St										
032-05	1.5							7,700			9,100	
		Highway 26										
		Grey Cty Rd 19										
034-01	1.6				2,500			2,700			2,800	
		CR 32 / Sixth St										
034-02	2.0				2,900			3,600			4,600	
		Blue Mountain Road										
034-03	2.7				2,100			2,500			2,800	
		Highway 26										

<u>Road# - Section #</u>	<u>Distance</u>	<u>Link Description</u>	<u>2010</u>	<u>2011</u>	<u>2012</u>	<u>2013</u>	<u>2014</u>	<u>2015</u>	<u>2016</u>	<u>2017</u>	<u>2018</u>	<u>2019</u>
		Barrie North Limits										
040-01	2.0				4,300			4,800			6,700	
		Dobson Road										
040-02	3.0				N/A			4,200			5,700	
		CR 28										
040-03	4.6				3,600			4,700			4,700	
		CR 90										
		Simcoe / Dufferin Boundary										
042-01	5.5				4,100			4,400			4,900	
		CR 9										
042-02	8.5				4,700			4,900			5,600	
		Stayner South Limits										
		Hwy 26										
043-01	2.8				2,700			3,000			3,300	
		Wilson Drive / County Road 53										
043-02	4.5				1,400			1,600			1,500	
		CR 28										
		Hwy 12										
044-01	2.7			13,000			14,300			14,200		
		CR 45										
044-02	2.7			12,600			12,300			12,300		
		Casino Main Entrance										
044-04	3.1			4,200			4,000			4,700		
		Longford Mills Rd										
044-05	8.7			2,300			2,400			3,100		
		CR 169										
		CR 46 (503)										
045-01	9.1			2,100			2,200			2,600		
		CR 169										
045-02	9.1			2,900			2,800			3,200		
		CR 44										
		CR 169										
046-01	6.0			1,800			1,900			2,500		
		Simcoe / Victoria Boundary										
046-02	5.8			500			500			550		
		CR 45 @ Sebright										
		Hwy 12										
047-01	3.6			900			1,000			1,500		
		5th Sideroad/ Ramara										
047-02	3.0			1,400			1,800			2,000		
		Conc 4, Simcoe/Victoria Boundary										
047-03	5.1			900			1,100			1,100		
		Sylvan Glen										

<u>Road# - Section #</u>	<u>Distance</u>	<u>Link Description</u>	<u>2010</u>	<u>2011</u>	<u>2012</u>	<u>2013</u>	<u>2014</u>	<u>2015</u>	<u>2016</u>	<u>2017</u>	<u>2018</u>	<u>2019</u>
		Orillia Limits										
049-01	0.8			8,900			9,100			9,300		
		Hwy 11 Overpass										
049-02	1.4			4,500			5,000			4,900		
		Hwy 11 on Ramp at Forest Hills										
		Hwy 9										
050-01	10.0		6,100			6,700			7,300			9,200
		CR 1										
050-02	10.0		4,800			6,100			7,100			7,000
		Hwy 89										
		10th S.R. / Ramara										
052-01	6.3			800			900			1,500	1,500	
		Muskoka Rd										
052-02	0.7			1,700			1,500			1,900	1,900	
		Hwy 11 Ramp										
		Hwy 26										
053-01	2.0				4,100			4,700			7,400	
		CR 43										
053-02	3.5				6,800			5,400			10,400	
		CR 40										
053-03	0.4				6,400			5,700			10,600	
		Barrie Limits										
		McKay Road										
053-04	2.0					7,900			8,400			8,700
		CR 21										
053-05	9.6					2,600			3,600			3,600
		Hwy 89										
053-06	11.3					2,000			2,600			3,000
		County Road 88										
		10th Line, Innisfil										
054-01	2.7		7,200			6,400			9,100			8,900
		CR 21										
054-02	9.6					2,700			5,100			5,200
		Hwy 89										
054-03	8.5					3,500			5,300			5,500
		9th Line Bradford										
		Hwy 89										
056-01	9.0		2,500			3,100			3,400			4,100
		CR 21										
056-02	9.3		2,600			3,600			3,600			4,300
		CR 90										
		CR 23										
058-01	9.3			1,600			2,400			2,100	2,100	
		Hwy 12										
		Hwy 26										
064-01	1.5				700			800			800	
		Nottawasaga Site 10										

Road# - Section #	Distance	Link Description	2010	2011	2012	2013	2014	2015	2016	2017	2018	2019
		Middletown Rd - 10th S.R.										
088-01	4.4		18,200			N/A			N/A	26,000	26,000	
		Hwy 400										
088-02	3.8		7,000			6,600			8,300			7,400
		Rd 27										
		CR 4										
089-01	2.7		6,500			6,000			7,900			8,700
		10th SideRoad / CR 54										
089-02	2.7		7,200			7,800			10,300			11,000
		Hwy 400										
		Barrie Limits @ Tiffen St										
090-01	1.0		17,000		17,400			19,400				19,600
		CR 27										
090-02	2.0		19,400		20,700			N/A				22,200
		CR 28										
090-03	2.7		16,500		16,100			N/A				18,000
		CR 40 / Old Pinegrove Rd										
090-04	1.7		17,900		N/A			16,500				19,400
		CR 56										
090-05	5.5		16,500		15,100			16,500				15,200
		CR 10 / N. Junction to Brentwood										
090-06	2.1		14,500		14,100			13,800				N/A
		CFB Borden										
		Stayner / W Limits										
091-01	8.3				5,200			4,600			5,500	
		CR 124 / Duntroon										
		Elmvale / W Limits										
092-01	4.0				5,700			4,800			4,700	
		CR 29										
092-02	5.3				7,700			7,500			7,900	
		Wasaga Beach										
		Georgian Drive										
093-02	2.3				6,100			7,500			7,300	
		Hwy 11										
093-03	6.2				4,000			4,100			3,900	
		CR 11 / Forbes Rd / Dalston										
093-04	6.3				3,800			3,600			3,900	
		CR 22 / Craighurst										
093-05	2.6				3,200			2,900			3,200	
		Hwy 400										
		Hwy 12										
093-06	2.0				N/A			13,300			16,000	
		CR 25 / Yonge St										
093-07	0.5				N/A			N/A		16,000		
		Hugel Ave										
093-08	1.0				N/A			N/A		16,000		
		Vinden St										
093-09	1.5				N/A			N/A		18,000		
		Penetang / S Limit										

<u>Road# - Section #</u>	<u>Distance</u>	<u>Link Description</u>	<u>2010</u>	<u>2011</u>	<u>2012</u>	<u>2013</u>	<u>2014</u>	<u>2015</u>	<u>2016</u>	<u>2017</u>	<u>2018</u>	<u>2019</u>
		Singhampton - CR 124										
095-01	4.9				1,100			1,200			1,600	
		County Road 91										
		Hwy 26										
096-01	2.6				3,600			5,500			7,000	
		CR 7										
		Simcoe / Dufferin Cty Boundary										
124-01	10.0				2,900			3,700			4,600	
		Grey Rd 4										
124-02	1.2				4,000			5,000			6,000	
		Singhampton Corner										
124-03	5.3				3,600			4,600			5,000	
		8th Conc Nottawasaga										
124-04	3.8				3,600			5,000			4,800	
		CR 91 / Duntroon										
124-05	5.4				5,600			4,800			6,000	
		33/34 SR Nottawasaga										
124-06	3.8				8,600			8,000			9,000	
		Poplar SR / Collingwood Limit										
		Hwy 12										
169-01	11.7			2,800			2,800			3,700		
		CR 45										
169-02	12.5			3,100			3,000			3,900		
		CR 44										
169-03	0.6			7,200			7,000			8,500		
		Quetton St										
169-04	0.2			7,000			7,100			8,700		
		Hwy 11 Ramp Junction										

TOTAL STATIONS 177



**TRANSPORTATION AND
ENGINEERING**

County of Simcoe

Transportation & Engineering

Annual Average Daily Traffic Summary (A.A.D.T.)

Updated Nov 2020

Road# - Section #	Distance	Link Description	2011	2012	2013	2014	2015	2016	2017	2018	2019	2020*
		CR 27										
001-01	6.1	15th SR New Tecumseth			3,900			4,300			4,400	
001-02	2.0				4,400			4,700			4,800	
		East Limits / Beeton										
001-03	1.9				4,400			4,600			4,500	
		CR 10										
001-04	3.1	Adj/Tos Townline			2,400			3,300			4,000	
001-04A	2.9				2,800			4,000			4,700	
		CR 50										
001-05	7.2	Simcoe Boundary			1,900			2,400			2,200	
		CR 39										
003-01	3.1				4,100			6,000			6,500	
		CR 4										
		Bradford Limits										
004-01	9.8				14,800			18,400			18,000	
		CR 89 / CR 3										
004-02	4.4				11,500			11,300			12,000	
		Line 4 / Churchill										
004-03	5.5				10,800			11,200			11,500	
		CR 21										
004-04	2.8	Victoria St. / Stroud			11,900			12,000			11,000	
004-05	2.9	Lockhart Dr. / Barrie Limit			13,600			14,100			12,500	
		CR 15										
005-01	4.1				4,000			4,500			4,100	
		CR 13										
005-02	5.6	County Boundary			1,800			2,500			2,900	
		CR 27 N										
006-01	5.5	Conc 4 / Tiny	4,600			4,600			5,000			4,800
006-02	8.2	CR 25 / Perkinsfield	4,200			4,400			4,900			5,400
006-03	1.4	Conc 11/ Tiny	4,700			5,000			4,700			6,300
006-04	2.8	Conc 13 / Tiny	3,900			4,300			4,800			5,400
006-05	4.1	CR 26	3,200			3,600			4,300			4,400

Road# - Section #	Distance	Link Description	2011	2012	2013	2014	2015	2016	2017	2018	2019	2020*
		Hwy 26										
007-01	4.5	Wasaga South Limit		5,500			7,500			9,500		
		CR 10										
009-01	4.3	6 / 7 SR, Creemore Ave		3,400			3,600			3,600		
009-02	3.8	Centre Line Road		2,000			2,200			2,200		
009-03	2.7	CR 42 / Cashtown Corners		2,500			2,800			3,400		
009-04	2.5	Fairgrounds Road		3,200			N/A			3,800		
009-05	6.7	Conc 8 / Clearview		850			850			1,100		
009-06	6.1	CR 124		550			600			700		
		Hwy 9										
010-01	2.7	CR 14			7,300			9,500			9,200	
010-02	4.2	CR 1			6,900			8,200			6,800	
010-03	8.0	Industrial Rd / 14th Conc			8,300			8,500			7,100	
010-04	0.5	Honda Entrance			10,600			12,000	12,700			
010-05	2.5	Hwy 89			9,000				15,000			
010-06	9.2	CR 21			6,100			7,400			7,600	
010-07	8.8	CR 90			5,500			6,700			7,000	
010-08	7.3	CR 9			9,200			9,600			9,900	
010-09	10.0	Hwy 26			5,400			5,400			6,000	
010-10	4.4	Wasaga Beach Limits			3,700			3,800			5,200	
		Hwy 11										
011-01	5.3	12th Conc / Oro - Rugby	3,400			3,900			5,200			5,200
011-02	13.1	3rd Line Oro	2,100			2,300			3,300			3,200
011-03	5.5	CR 93	2,600			3,100			3,900			4,100
011-04	1.0	Hwy 400	3,300			3,700			4,600			4,600

Road# - Section #	Distance	Link Description	2011	2012	2013	2014	2015	2016	2017	2018	2019	2020*
012-01	3.9	CR 13			1,400			1,700			1,900	
		County Boundary										
		Hwy 89										
013-01	5.7	CR 5			2,500			3,000			3,700	
013-02	9.5	CR 12			2,900			2,100			2,200	
		CR 50										
014-01	3.8	Adjala-New Tech Townline			1,200			900			1,100	
014-02	2.9	CR 10			1,700			1,700			1,900	
		CR 27										
014-03	3.0	Highway 400									3,700	
		Victoria St. / Alliston										
015-01A	1.1	Essa Rd			9,100			N/A			N/A	
015-01	4.7	CR 5			5,200			5,200			5,200	
015-02	3.5	CR 21			4,800			5,000			5,500	
015-03	1.2	Base Borden South Limit			2,100			2,100			2,100	
		CR 23										
016-01	6.2	Hwy 400	5,100			4,200			5,100			5,100
		Coldwater / North Limits										
017-01	6.8	Quarry Road	1,500			1,600			1,600			1,700
017-02	4.3	4th Conc. Silcline	1,200			750			1,100			850
017-03	11.9	Big Chute	400			300			320			650
		Hwy 12										
019-01	2.5	Hwy 400	1,200			1,200			1,700			1,500
019-02	2.0	8th Conc / Moonstone	1,600			1,700			2,000			2,000
019-03	10.8	Hwy 93	1,000			1,100			1,600			1,300
019-04	8.1	CR 27	1,900			1,700			1,900			2,300
		Barrie Limits										
020-01	7.4	Line 3 Oro-Medonte	3,100			2,600			2,900			2,900
020-02	6.0	Line 7 Oro-Medonte	1,500			1,500			1,900			1,900
020-03	6.2	Line 11 Oro-Medonte	1,000			1,000			1,200			1,300
020-04	1.1	Line 11 / Hwy 11	1,800			1,700			2,100			2,200

Road# - Section #	Distance	Link Description	2011	2012	2013	2014	2015	2016	2017	2018	2019	2020*
		CR 39										
021-01	3.0				12,200			14,700			13,300	
		CR 4										
021-02	3.1				11,800			13,900			13,300	
		CR 54 (10th SR)										
021-03	2.2				13,700			18,300			16,600	
		Hwy 400										
021-04	0.6				13,200			17,000			15,400	
		5th SR Innisfil										
021-05	3.0				9,300			11,100			10,800	
		CR 27										
021-06	6.4				6,000			7,400			7,000	
		CR 56										
021-07	4.2				6,300			6,800			7,500	
		CR10										
021-08	4.2				4,900			5,700			6,100	
		CR 15										
		Hwy 12										
022-01	9.6		4,300			4,600			5,800			6,100
		Coulson/ 7th Line										
022-02	4.9		4,300			4,600			5,100			5,600
		Horseshoe Valley Resort Ent.										
022-03	5.2		5,500			5,300			6,800			7,500
		CR 93										
022-04	1.4		5,800			6,300			7,100			7,800
		Hwy 400										
022-05	4.6		5,600			6,100			7,100			8,100
		CR 27										
022-06	2.6		4,400			4,600			5,600			6,500
		Wilson Drive - Anten Mills										
022-07	3.9		3,900			4,100			5,100			5,900
		CR 29										
022-08	0.5		6,200			6,400			8,200			N/A
		Hwy 26										
		Hwy 400										
023-01	4.7		1,800			2,800			2,100			2,300
		Gervais Rd										
023-02	5.6		1,900			2,800			2,500			2,400
		CR 58										
023-03	5.0		1,900			2,200			2,300			2,400
		Hwy 93										
		CR 93										
025-01	2.9			5,900			6,000			6,700		
		2nd Conc / Baseline Rd										
025-02	3.2			4,200			4,300			4,700		
		CR 6										
		Robert St / Penetang										
026-01	4.3			2,400			2,500			4,400		
		16th Conc										
026-02	3.1			2,100			2,100			2,200		
		CR 6										
026-03	3.0			2,700			2,800			3,100		
		Cedar Point Rd - 19/18 SR										

Road# - Section #	Distance	Link Description	2011	2012	2013	2014	2015	2016	2017	2018	2019	2020*
		Hwy 9										
027-01	9.7	CR 88			6,700			8,300			8,100	
027-02	11.5	Hwy 89			5,100			6,500			5,400	
027-03	9.8	CR 21 / North Junction			5,500			6,700			5,100	
027-04	3.1	Essa Road			9,800			10,500			9,500	
027-05	6.8	(old Hwy 131) CR 90			10,200			12,200			11,000	
		Hwy 26										
027-07	7.6	CR 22		11,200			10,900			11,100		
027-08	11.3	Elmvale South Limits		10,100			10,500			11,000		
027-09	2.2	CR 6		9,000			8,700			8,900		
027-10	7.6	Hwy 93 / Wyevale		4,000			4,100			4,000		
		CR 90										
028-01	1.9	CR 40	5,200			4,600			6,800			6,400
028-02	4.7	CR 43	4,700			5,100			7,300			7,000
028-03	5.1	Hwy 26	4,600			5,200			6,800			6,500
		CR 22										
029-01	4.1	Flos Road 4		3,900			4,400			5,200		
029-02	6.8	CR 92		4,000			4,000			4,700		
029-03	7.8	Conc 4/ Tiny		2,500			2,400			2,900		
		CR 34										
032-01	2.7	10th Concession		3,200			4,000			4,700		
032-02	1.9	Poplar SR			2,700		3,000			4,400		
032-03	2.6	CR 124					2,900			4,400		
032-04	1.5	Raglan St					9,600			10,200		
032-05	1.5	Highway 26					7,700			9,100		
		Grey Cty Rd 19										
034-01	1.6	CR 32 / Sixth St		2,500			2,700			2,800		
034-02	2.0	Blue Mountain Road		2,900			3,600			4,600		
034-03	2.7	Highway 26		2,100			2,500			2,800		

Road# - Section #	Distance	Link Description	2011	2012	2013	2014	2015	2016	2017	2018	2019	2020*
		Barrie North Limits										
040-01	2.0			4,300			4,800			6,700		
		Dobson Road										
040-02	3.0			N/A			4,200			5,700		
		CR 28										
040-03	4.6			3,600			4,700			4,700		
		CR 90										
		Simcoe / Dufferin Boundary										
042-01	5.5			4,100			4,400			4,900		
		CR 9										
042-02	8.5			4,700			4,900			5,600		
		Stayner South Limits										
		Hwy 26										
043-01	2.8			2,700			3,000			3,300		
		Wilson Drive / County Road 53										
043-02	4.5			1,400			1,600			1,500		
		CR 28										
		Hwy 12										
044-01	2.7		13,000			14,300			14,200			8,600
		CR 45										
044-02	2.7		12,600			12,300			12,300			6,100
		Casino Main Entrance										
044-03	3.1		4,200			4,000			4,700			3,500
		Longford Mills Rd										
044-04	8.7		2,300			2,400			3,100			2,400
		CR 169										
		CR 46 (503)										
045-01	9.1		2,100			2,200			2,600			2,800
		CR 169										
045-02	9.1		2,900			2,800			3,200			3,300
		CR 44										
		CR 169										
046-01	6.0		1,800			1,900			2,500			2,500
		Simcoe / Victoria Boundary										
046-02	5.8		500			500			550			600
		CR 45 @ Sebright										
		Hwy 12										
047-01	3.6		900			1,000			1,500			1,100
		5th Sideroad/ Ramara										
047-02	3.0		1,400			1,800			2,000			1,600
		Conc 4, Simcoe/Victoria Boundary										
047-03	5.1		900			1,100			1,100			1,200
		Sylvan Glen										

Road# - Section #	Distance	Link Description	2011	2012	2013	2014	2015	2016	2017	2018	2019	2020*
		Orillia Limits										
049-01	0.8		8,900			9,100			9,300			7,600
		Hwy 11 Overpass										
049-02	1.4		4,500			5,000			4,900			N/A
		Hwy 11 on Ramp at Forest Hills										
		Hwy 9										
050-01	10.0				6,700			7,300			9,200	
		CR 1										
050-02	10.0				6,100			7,100			7,000	
		Hwy 89										
		10th S.R. / Ramara										
052-01	6.3		800			900			1,500			1,700
		Muskoka Rd										
052-02	0.7		1,700			1,500			1,900			1,800
		Hwy 11 Ramp										
		Hwy 26										
053-01	2.0			4,100			4,700			7,400		
		CR 43										
053-02	3.5			6,800			5,400			10,400		
		CR 40										
053-03	0.4			6,400			5,700			10,600		
		Barrie Limits										
		McKay Road										
053-04	2.0				7,900			8,400			8,700	
		CR 21										
053-05	9.6				2,600			3,600			3,600	
		Hwy 89										
053-06	11.3				2,000			2,600			3,000	
		County Road 88										
		10th Line, Innisfil										
054-01	2.7				6,400			9,100			8,900	
		CR 21										
054-02	9.6				2,700			5,100			5,200	
		Hwy 89										
054-03	8.5				3,500			5,300			5,500	
		9th Line Bradford										
		Hwy 89										
056-01	9.0				3,100			3,400			4,100	
		CR 21										
056-02	9.3				3,600			3,600			4,300	
		CR 90										
		CR 23										
058-01	9.3		1,600			2,400			2,100			2,000
		Hwy 12										
		Hwy 26										
064-01	1.5			700			800			800		
		Nottawasaga Site 10										

Road# - Section #	Distance	Link Description	2011	2012	2013	2014	2015	2016	2017	2018	2019	2020*
		Middletown Rd - 10th S.R.										
088-01	4.4				N/A			N/A	26,000			
		Hwy 400										
088-02	3.8				6,600			8,300			7,400	
		Rd 27										
		CR 4										
089-01	2.7				6,000			7,900			8,700	
		10th SideRoad / CR 54										
089-02	2.7				7,800			10,300			11,000	
		Hwy 400										
		Barrie Limits @ Tiffen St										
090-01	1.0			17,400			19,400				19,600	
		CR 27										
090-02	2.0			20,700			N/A				22,200	
		CR 28										
090-03	2.7			16,100			N/A				18,000	
		CR 40 / Old Pinegrove Rd										
090-04	1.7			N/A			16,500				19,400	
		CR 56										
090-05	5.5			15,100			16,500				15,200	
		CR 10 / N. Junction to Brentwood										
090-06	2.1			14,100			13,800				N/A	
		CFB Borden										
		Stayner / W Limits										
091-01	8.3			5,200			4,600			5,500		
		CR 124 / Duntroon										
		Elmvale / W Limits										
092-01	4.0			5,700			4,800			4,700		
		CR 29										
092-02	5.3			7,700			7,500			7,900		
		Wasaga Beach										
		Georgian Drive										
093-02	2.3			6,100			7,500			7,300		
		Hwy 11										
093-03	6.2			4,000			4,100			3,900		
		CR 11 / Forbes Rd / Dalston										
093-04	6.3			3,800			3,600			3,900		
		CR 22 / Craighurst										
093-05	2.6			3,200			2,900			3,200		
		Hwy 400										
		Hwy 12										
093-06	2.0			N/A			13,300			16,000		
		CR 25 / Yonge St										
093-07	0.5			N/A			N/A		16,000			
		Hugel Ave										
093-08	1.0			N/A			N/A		16,000			
		Vinden St										
093-09	1.5			N/A			N/A		18,000			
		Penetang / S Limit										

Road# - Section #	Distance	Link Description	2011	2012	2013	2014	2015	2016	2017	2018	2019	2020*
		Singhampton - CR 124										
095-01	4.9	County Road 91		1,100			1,200			1,600		
		Hwy 26										
096-01	2.6	CR 7		3,600			5,500			7,000		
		Simcoe / Dufferin Cty Boundary										
124-01	10.0	Grey Rd 4		2,900			3,700			4,600		
124-02	1.2	Singhampton Corner		4,000			5,000			6,000		
124-03	5.3	8th Conc Nottawasaga		3,600			4,600			5,000		
124-04	3.8	CR 91 / Duntroon		3,600			5,000			4,800		
124-05	5.4	33/34 SR Nottawasaga		5,600			4,800			6,000		
124-06	3.8	Poplar SR / Collingwood Limit		8,600			8,000			9,000		
		Hwy 12										
169-01	11.7	CR 45	2,800			2,800			3,700			3,800
169-02	12.5	CR 44	3,100			3,000			3,900			4,200
169-03	0.6	Quetton St	7,200			7,000			8,500			8,200
169-04	0.2	Hwy 11 Ramp Junction	7,000			7,100			8,700			8,500

TOTAL STATIONS 177

County Road 6 - Fall 2020
 Concession 4 / Tiny to
 County Road 25

County of Simcoe
 Transportation and Engineering Department
 Midhurst, Ontario
 (705)-726-9300

Site Code: 006 02

Date Start: 21-Sep-20
 Date End: 24-Sep-20

Start Time	21-Sep-20		Tue		Wed		Thu		Fri		Sat		Sun		Week Average	
	SB	NB	SB	NB	SB	NB	SB	NB	SB	NB	SB	NB	SB	NB	SB	NB
12:00 AM	4	8	2	5	3	10	2	6	*	*	*	*	*	*	3	7
01:00	2	6	2	9	2	9	3	12	*	*	*	*	*	*	2	9
02:00	2	5	1	6	4	8	4	6	*	*	*	*	*	*	3	6
03:00	2	6	5	4	8	2	9	4	*	*	*	*	*	*	6	4
04:00	33	3	33	4	39	4	29	5	*	*	*	*	*	*	34	4
05:00	66	9	71	8	65	9	57	12	*	*	*	*	*	*	65	10
06:00	96	57	112	64	109	69	120	64	*	*	*	*	*	*	109	64
07:00	151	143	177	153	163	147	166	127	*	*	*	*	*	*	164	142
08:00	195	156	194	166	161	148	162	175	*	*	*	*	*	*	178	161
09:00	160	145	170	152	144	144	136	142	*	*	*	*	*	*	152	146
10:00	158	148	166	156	142	138	173	157	*	*	*	*	*	*	160	150
11:00	183	160	177	154	154	143	148	187	*	*	*	*	*	*	166	161
12:00 PM	169	148	157	171	180	178	189	201	*	*	*	*	*	*	174	174
01:00	193	164	198	173	205	165	189	198	*	*	*	*	*	*	196	175
02:00	183	166	204	189	189	187	192	211	*	*	*	*	*	*	192	188
03:00	183	178	201	221	189	195	220	217	*	*	*	*	*	*	198	203
04:00	186	222	228	228	213	227	279	271	*	*	*	*	*	*	226	237
05:00	179	209	181	221	193	232	187	252	*	*	*	*	*	*	185	228
06:00	135	160	122	199	131	206	104	188	*	*	*	*	*	*	123	188
07:00	101	94	104	118	112	116	85	182	*	*	*	*	*	*	100	128
08:00	56	77	63	79	65	84	57	103	*	*	*	*	*	*	60	86
09:00	26	42	29	57	36	47	38	94	*	*	*	*	*	*	32	60
10:00	17	21	19	27	12	28	11	50	*	*	*	*	*	*	15	32
11:00	14	11	9	13	15	20	13	23	*	*	*	*	*	*	13	17
Lane Day	2494	2338	2625	2577	2534	2516	2573	2887	0	0	0	0	0	0	2556	2580
AM Peak	08:00	11:00	08:00	08:00	07:00	08:00	10:00	11:00	-	-	-	-	-	-	08:00	08:00
Vol.	195	160	194	166	163	148	173	187	-	-	-	-	-	-	178	161
PM Peak	13:00	16:00	16:00	16:00	16:00	17:00	16:00	16:00	-	-	-	-	-	-	16:00	16:00
Vol.	193	222	228	228	213	232	279	271	-	-	-	-	-	-	226	237

Comb. Total	4832	5202	5050	5460	0	0	0	5136
ADT	ADT 5,136	AADT 5,136						

County Road 6 - Summer 2020
 Conc 4 Tiny to
 County Road 25 / Perkinsfield

County of Simcoe
 Transportation and Engineering Department
 Midhurst, Ontario
 (705)-726-9300

Site Code: 006 02

Date Start: 13-Jul-20
 Date End: 16-Jul-20

Start Time	13-Jul-20		Tue		Wed		Thu		Fri		Sat		Sun		Week Average	
	SB	NB	SB	NB	SB	NB	SB	NB	SB	NB	SB	NB	SB	NB	SB	NB
12:00 AM	6	18	5	10	8	17	7	16	*	*	*	*	*	*	6	15
01:00	4	12	5	6	5	9	6	6	*	*	*	*	*	*	5	8
02:00	1	7	3	5	1	8	8	8	*	*	*	*	*	*	3	7
03:00	8	9	11	9	10	8	10	9	*	*	*	*	*	*	10	9
04:00	27	2	22	3	28	3	26	1	*	*	*	*	*	*	26	2
05:00	48	14	67	13	62	18	73	18	*	*	*	*	*	*	62	16
06:00	90	65	108	66	125	67	117	63	*	*	*	*	*	*	110	65
07:00	134	140	152	120	146	124	141	122	*	*	*	*	*	*	143	126
08:00	143	159	160	129	175	138	164	119	*	*	*	*	*	*	160	136
09:00	166	178	159	138	153	134	168	144	*	*	*	*	*	*	162	148
10:00	195	170	198	155	196	191	194	160	*	*	*	*	*	*	196	169
11:00	183	190	165	214	190	182	213	175	*	*	*	*	*	*	188	190
12:00 PM	224	175	177	236	218	226	222	207	*	*	*	*	*	*	210	211
01:00	219	196	207	239	232	201	197	197	*	*	*	*	*	*	214	208
02:00	226	226	198	227	195	218	201	223	*	*	*	*	*	*	205	224
03:00	235	182	224	231	213	211	228	251	*	*	*	*	*	*	225	219
04:00	226	210	243	236	218	282	204	293	*	*	*	*	*	*	223	255
05:00	178	221	209	200	185	245	185	286	*	*	*	*	*	*	189	238
06:00	140	160	182	180	157	209	111	214	*	*	*	*	*	*	148	191
07:00	142	115	147	155	157	169	121	155	*	*	*	*	*	*	142	148
08:00	87	89	106	112	111	114	64	149	*	*	*	*	*	*	92	116
09:00	52	55	97	84	77	87	36	90	*	*	*	*	*	*	66	79
10:00	35	37	39	35	44	44	16	50	*	*	*	*	*	*	34	42
11:00	22	23	17	15	26	25	21	26	*	*	*	*	*	*	22	22
Lane Day	2791	2653	2901	2818	2932	2930	2733	2982	0	0	0	0	0	0	2841	2844
AM Peak Vol.	10:00 195	11:00 190	10:00 198	11:00 214	10:00 196	10:00 191	11:00 213	11:00 175	-	-	-	-	-	-	10:00 196	11:00 190
PM Peak Vol.	15:00 235	14:00 226	16:00 243	13:00 239	13:00 232	16:00 282	15:00 228	16:00 293	-	-	-	-	-	-	15:00 225	16:00 255

Comb. Total	5444	5719	5862	5715	0	0	0	5685
ADT	ADT 5,685	AADT 5,685						

APPENDIX “B”

Figures No. 2,3,4 & 5

COUNTY RD 6 SOUTH

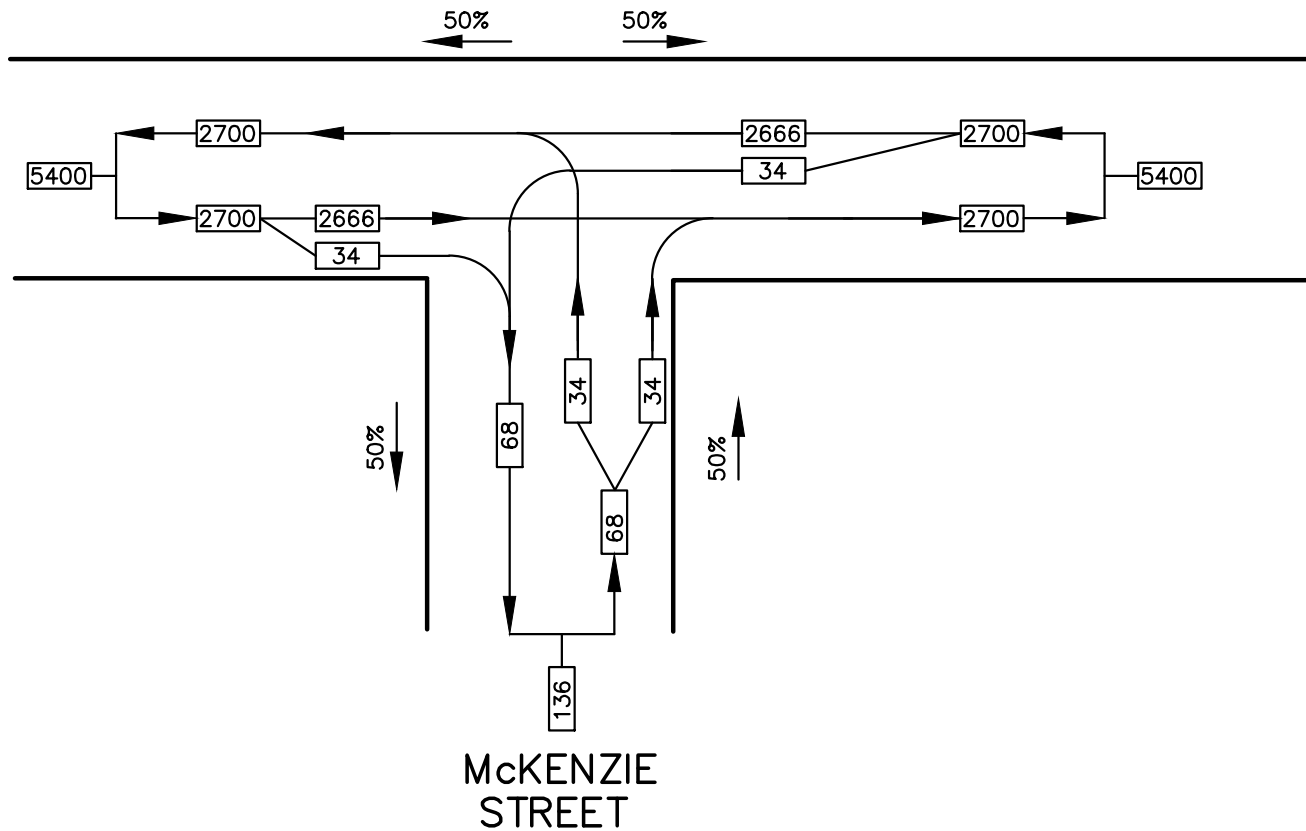

ConSALtech
Engineering Solutions

1249 Marshal Road, Tiny, Ontario, L0K 2E1
705-722-1878

**PRE-DEVELOPMENT
AADT TRAFFIC (2020)**

TRAFFIC BRIEF - 900 COUNTY ROAD 6 SOUTH

Checked	Drawn
Date APR 2022	Proj. No.
Scale NTS	Figure No. 2

COUNTY RD 6 SOUTH

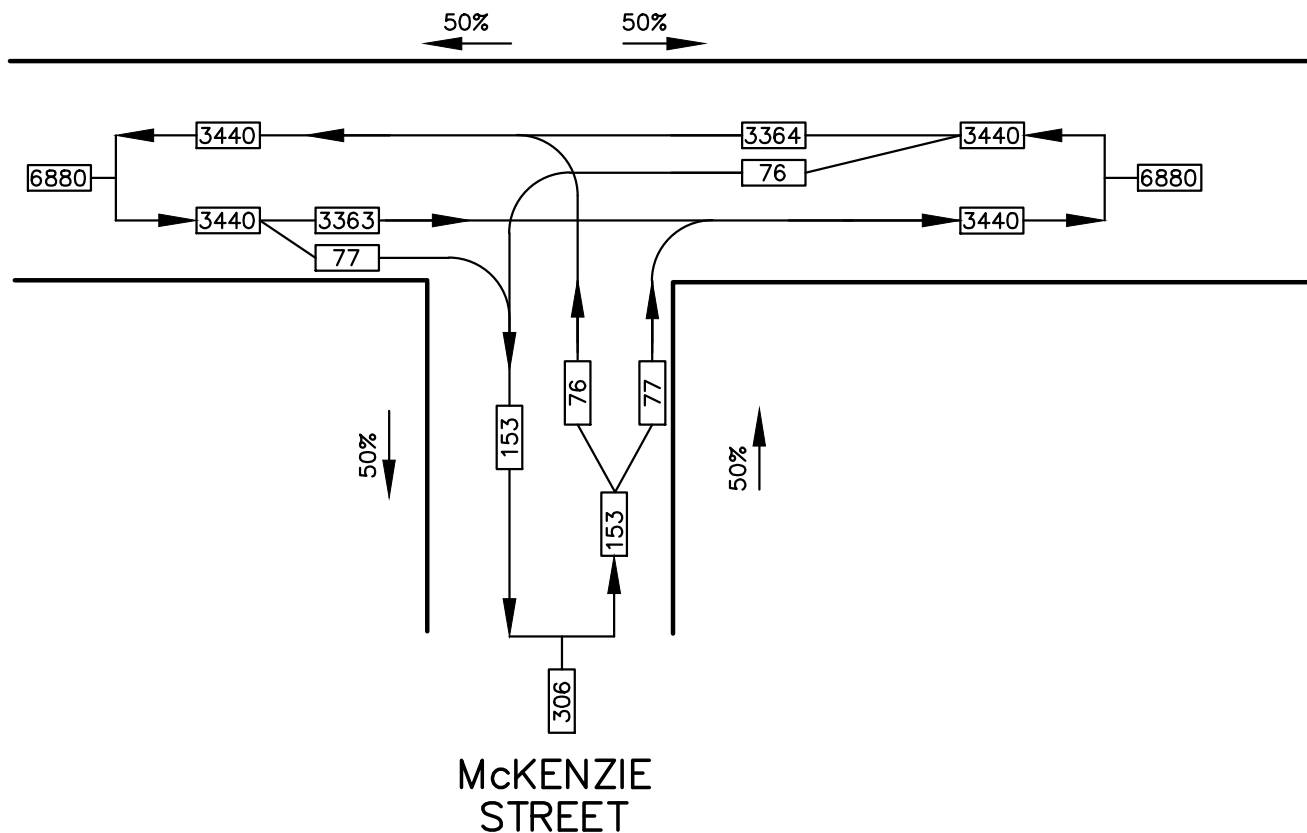

ConSALtech
Engineering Solutions

1249 Marshal Road, Tiny, Ontario, L0K 2E1
705-722-1878

**POST-DEVELOPMENT
AADT TRAFFIC (2027)**

TRAFFIC BRIEF - 900 COUNTY ROAD 6 SOUTH

Checked	Drawn
Date APR 2022	Proj. No.
Scale NTS	Figure No. 3

COUNTY RD 6 SOUTH

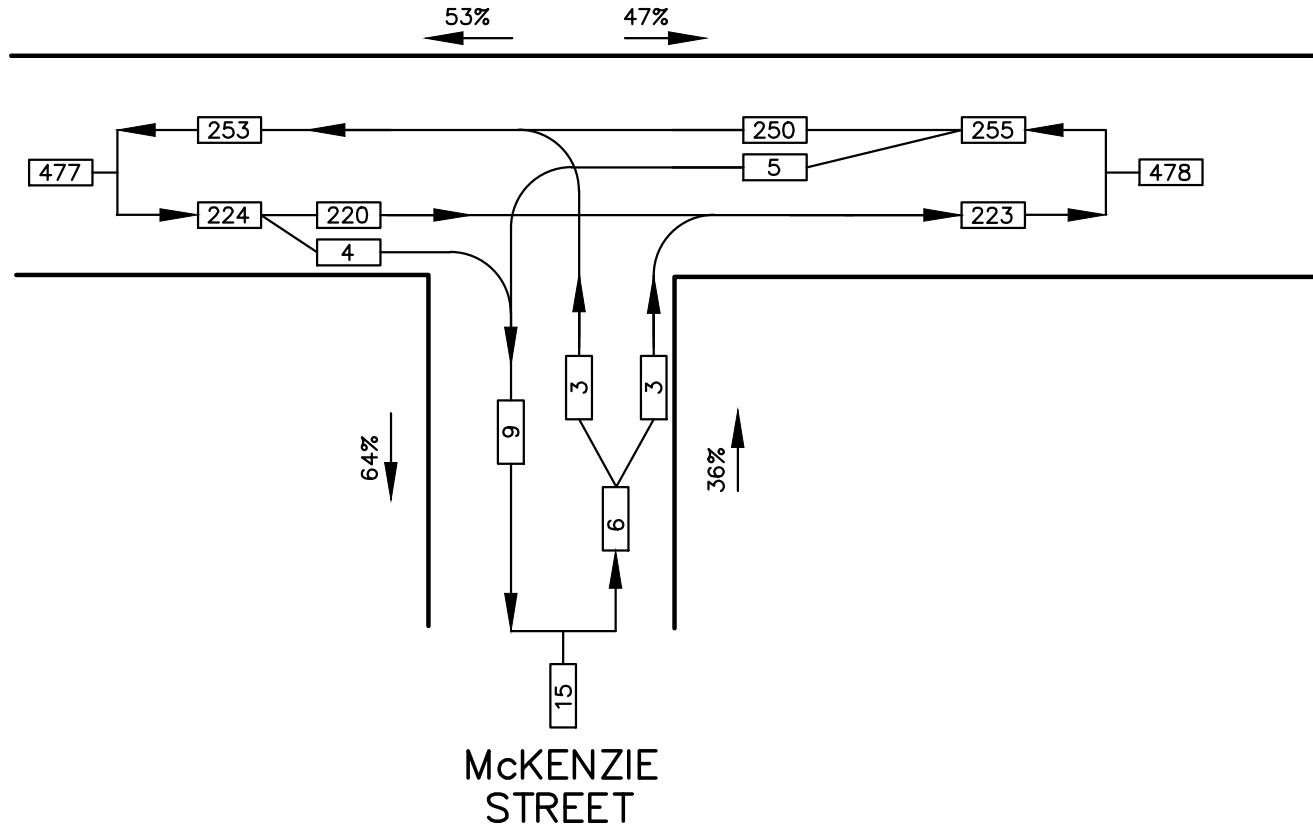

ConSALtech
Engineering Solutions

1249 Marshal Road, Tiny, Ontario, L0K 2E1
705-722-1878

PRE-DEVELOPMENT
PM PEAK HOUR TRAFFIC (2020)
TRAFFIC BRIEF - 900 COUNTY ROAD 6 SOUTH

Checked	Drawn
Date APR 2022	Proj. No.
Scale NTS	Figure No. 4

COUNTY RD 6 SOUTH

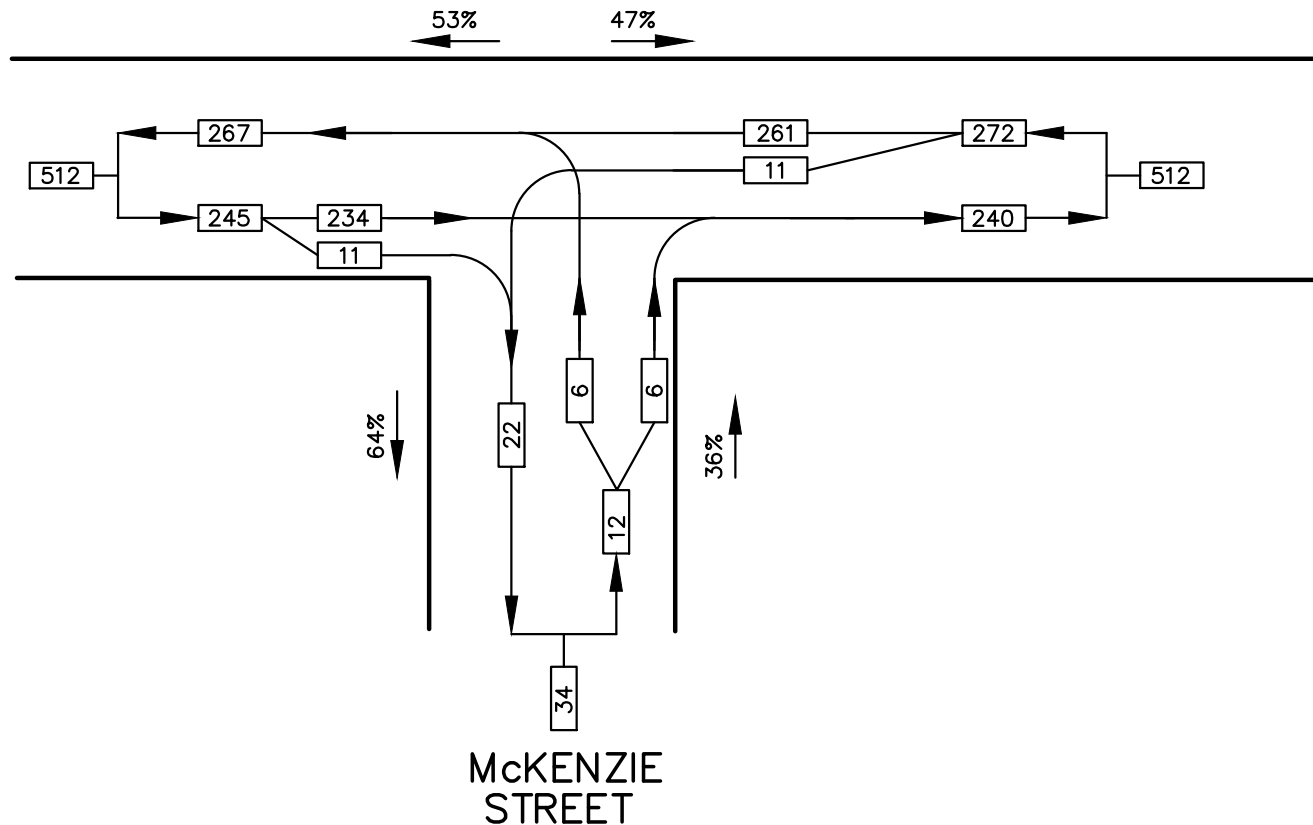

ConSALtech
Engineering Solutions

1249 Marshal Road, Tiny, Ontario, L0K 2E1
705-722-1878

POST-DEVELOPMENT PM PEAK HOUR TRAFFIC (2027)

TRAFFIC BRIEF - 900 COUNTY ROAD 6 SOUTH

Checked	Drawn
Date APR 2022	Proj. No.
Scale NTS	Figure No. 5

APPENDIX “C”

MTO Figure EA-2

Left Turn Lane Warrants

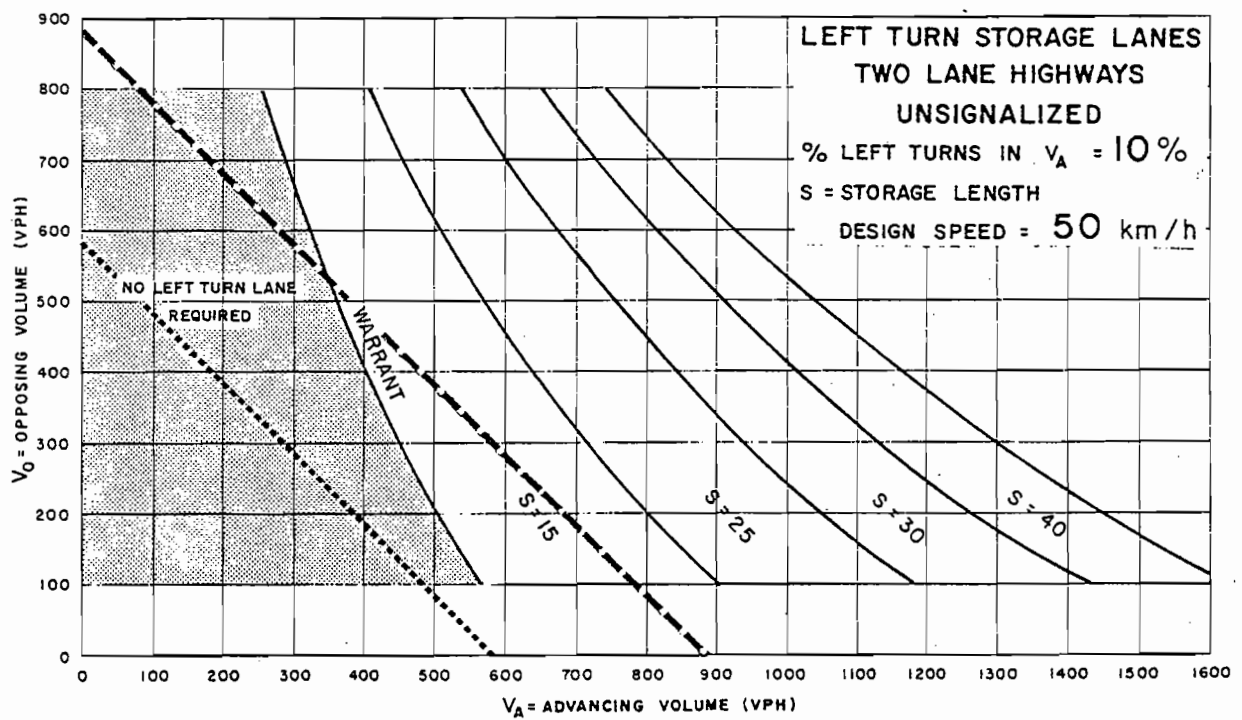
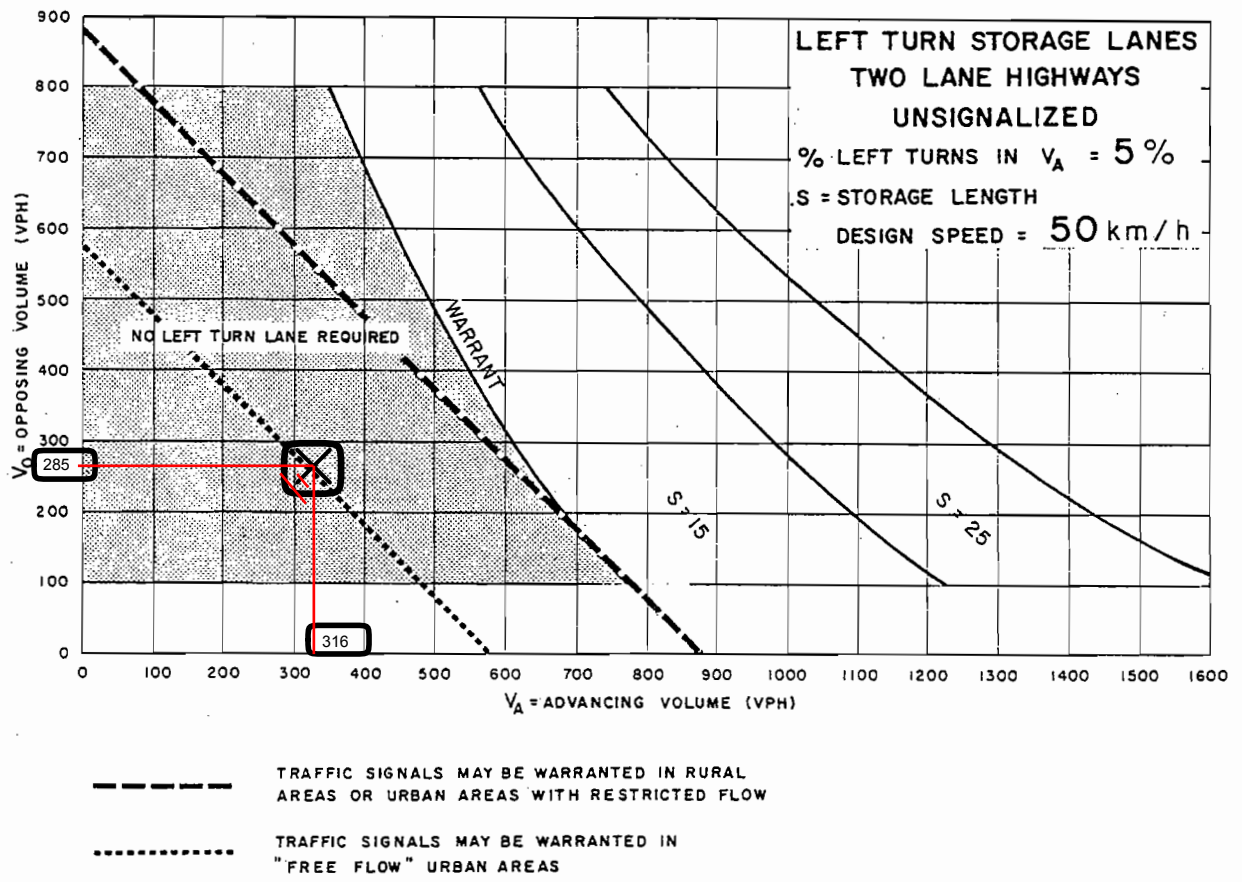

Figure EA-2