

ELECTRICAL SITE PLAN
SCALE: 1:500

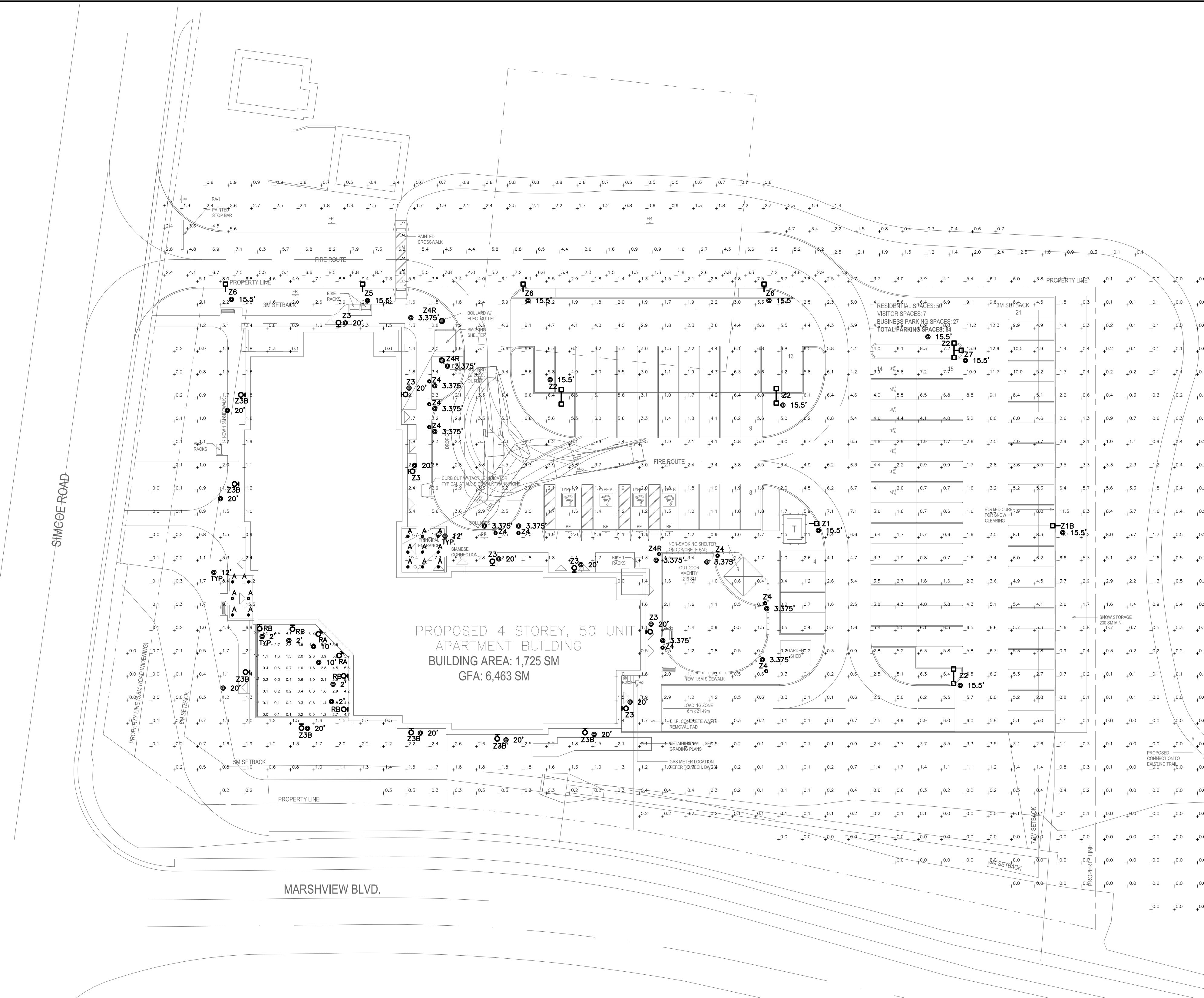

PROPOSED 4 STOREY, 50 UNIT
APARTMENT BUILDING
BUILDING AREA: 1,725 SM
GFA: 6,463 SM

Symbol	Label	Quantity	Manufacturer	Catalog Number	Description	Number Lamps	Lumens Per Lamp	Light Loss Factor	Wattage
•	A	15	GREEN CREATIVE LTD	RS-3000RHT	LED 3000K	1	1584	0.9	15.47
□	Z1	1	Industrial Lighting Products Inc	SAS-15L-U-30-14	Styleze small, 15,000 Lumens, 3000K, Type 4 Optic	1	16185	0.88	110.5
□	Z1B	1	Industrial Lighting Products Inc	SAS-15L-U-30-14	Styleze small, 15,000 Lumens, 3000K, Type 4 Optic	1	16185	0.88	221
□	Z2	4	Industrial Lighting Products Inc	SAS-15L-U-30-15S	Styleze small, 15,000 Lumens, 3000K, Type 5 Square Optic	1	16883	0.88	221
○	Z3	7	Industrial Lighting Products Inc	WPCN-44WLED-UHV-30-24	bronze tinted aluminum housing, clear plastic optics	1	4669	0.88	40.1105
○	Z3B	7	Industrial Lighting Products Inc	WPCN-28WLED-UHV-30-24	gray tinted aluminum housing, clear plastic optics	1	3356	0.88	26.6209
○	Z4	10	INTRUSIVE	AR-P8-21LED-3K	blue LED bollard	1	242	0.9	41.2
□	Z5	1	Industrial Lighting Products Inc	SAS-15L-U-30-13	Styleze small, 15,000 Lumens, 3000K, Type 3 Optic	1	16982	0.88	110.5
○	Z6	1	Industrial Lighting Products Inc	SAS-15L-U-30-14	Styleze small, 15,000 Lumens, 3000K, Type 4 Optic	1	16185	0.88	110.5
□	Z7	1	Industrial Lighting Products Inc	SAS-15L-U-30-14	Styleze small, 15,000 Lumens, 3000K, Type 4 Optic	1	16185	0.88	110.5
○	RA/RB	6	SCOTT ARCH	38040-124-39K-PT	Formed gray metal housing with diffuse plastic lens inner lens and clear glass outer lens	1	1274	0.9	23.66

Description	Symbol	Avg	Max	Min	Max/Min	Avg/Min
Entrance Road/Driveway	+	4.8 FC	8.8 FC	0.9 FC	9.8:1	5.3:1
Entrance	X	4.0 FC	6.9 FC	1.4 FC	4.9:1	2.9:1
Beyond Property Line	X	2.1 FC	9.4 FC	0.0 FC	N/A	N/A
Crosswalk	+	5.6 FC	6.6 FC	3.5 FC	1.9:1	1.6:1
Site	+	2.5 FC	15.4 FC	0.0 FC	N/A	N/A
Road/Driveway Beyond	+	1.4 FC	5.5 FC	0.1 FC	56.0:1	14.0:1

Note
1. Dimensions: Provided
2. Mounting Height: Provided
3. Calc. Zone: 0
4. Reflectances:

Calculations provided are estimates only.

No.	REVISION	DATE
03		
02	RE-ISSUED FOR SITE PLAN APPROVAL	APRIL 12/22
01	SITE PLAN APPROVAL	OCT. 14/21

ISSUED/REVISIONS

ALL DIMENSIONS TO BE CHECKED AND VERIFIED ON SITE. DISCREPANCIES TO BE REPORTED TO THE ARCHITECT. LATEST APPROVED STAMPED DRAWINGS ONLY TO BE USED FOR CONSTRUCTION.

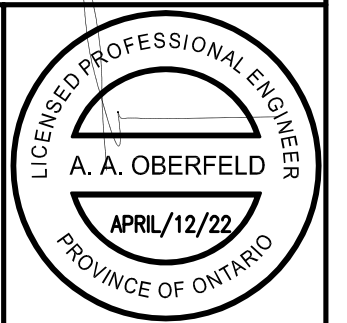

TRISTAR ENGINEERING
Division of 1041549 Ontario Limited
8901 Woodbine Avenue, Unit #116
Markham, Ontario
Canada, L3R 9Y4
(905) 604-3801
Fax (905) 604-3954

SITE PLAN LIGHTING CALCULATIONS

PROJECT NAME:
SIMCOE COUNTY AFFORDABLE HOUSING - BWG
125 SIMCOE RD, BRADFORD WEST
GWILLIMBURY, ON

DATE	PROJECT #	SHEET #
SEP. 2021	2021-123	LE1
DRAWN BY: DP/JP		
SCALE: 1:300		