



County of Simcoe
 Transportation and
 Engineering
 1110 Highway 26,
 Midhurst, Ontario L0L 1X0

Main Line (705) 726 9300
 Toll Free 1 866 893 9300
 Fax (705) 727 7984
 simcoe.ca



NOTICE

**County of Simcoe
 County Road 53 Seadon Road/Carson Road Intersection
 Improvements
 Construction Newsletter No. 5**

**Simcoe County Engineering, Planning & Environmental Division
 Transportation and Engineering Department
 October 06, 2023**

County Road 53 Seadon Road/Carson Road Intersection Improvements

The County of Simcoe has awarded the contract to Georgian Paving Inc. for the construction of the Wilson Drive (CR 53) Seadon Road/Carson Road Intersection Improvements.

The proposed construction limits are on County Road 53 from 300 m North and 350 m south of the intersection, 240 m on Seadon Road and 260 m on Carson Road

The work includes construction of a roundabout including grading, drainage, concrete, paving, landscaping and street lighting.

GEORGIAN Paving Inc. mobilized on **May 8, 2023**. The construction work is scheduled to continue through to **November 30, 2023**.

Lane Restrictions

During road reconstruction operations, traffic speed will be reduced by 20km/hr below the current posted speed limits within construction speed zone (County Road 53 from 672 m north and 685 m south of the intersection, 565 m on Seadon Road and 613 m on Carson Road

Temporary closure of one lane on weekdays (excluding holidays) is anticipated during working hours of 7:00 am to 7:00 pm (12:00 pm on Fridays preceding holidays).

The full closure of Carson and Seadon Roads at Wilson Dr for 5 weeks will begin September 11 till October 16, 2023 Detour routes will be posted. Detour route map is attached to this notification. **Wilson Drive will remain open for traffic during Carson & Seadon Closure.**

Exposed gravel driving surface may be encountered periodically during construction.

Advanced warning signs will be installed on CR 53 to warn motorists of the traffic disruptions.

Pre-Condition Survey and Well Sampling

EXP Consultants have been retained by the County to carry out well condition sampling and monitoring of homes in close proximity to the construction activities. Well inspection work notices have been distributed and testing has begun.

How will I get to My Property?

The Contractor will maintain access to your properties. On several occasions, however, direct access to CR 53, Carson and Seadon may be interrupted.

The contractor will give prior notice of any access restrictions to the property Owners.

If you have any special needs for wheelchair access, please advise the EXP Construction Inspector (Hamza Sajid).

Access for emergency vehicles will be maintained at all times.

Safety

Construction involves the use of heavy equipment and the unavoidable creation of obstacles. We ask that you caution your children to stay clear of the working area.

We ask that you take extra caution during the construction period to ensure everyone's safety.

Who Do I Call If I Have a Problem?

EXP Services Inc. is the project Contract Administrator and Georgian Paving Inc. is the project construction Contractor. If you have any questions regarding the construction, please call:

Field:

EXP Services Inc.
 Inspector
 Hamza Sajid
 Mobile – (437) 755-7623

GEORGIAN Paving Inc.
 Site Supervisor
 Rob McLean
 Mobile – (705) 444-4664

County of Simcoe
 Project Engineer
 Claire Walker, P. Eng, PMP
 Office – (705) 726-9300 Ext. 1168
 Mobile – (705) 795-9182

Office:

EXP Services Inc.
 Contract Administrator
 Katherine Kirkpatrick
 Mobile – (905) 409-4360

Georgian Paving Inc.
 Project Manager
 Tim Fawcett
 Mobile – (705) 333-5781

County of Simcoe
 Manager, Transportation
 Construction
 Julie Scruton, P. Eng Ext. 1176
 Office – (705) 726-9300

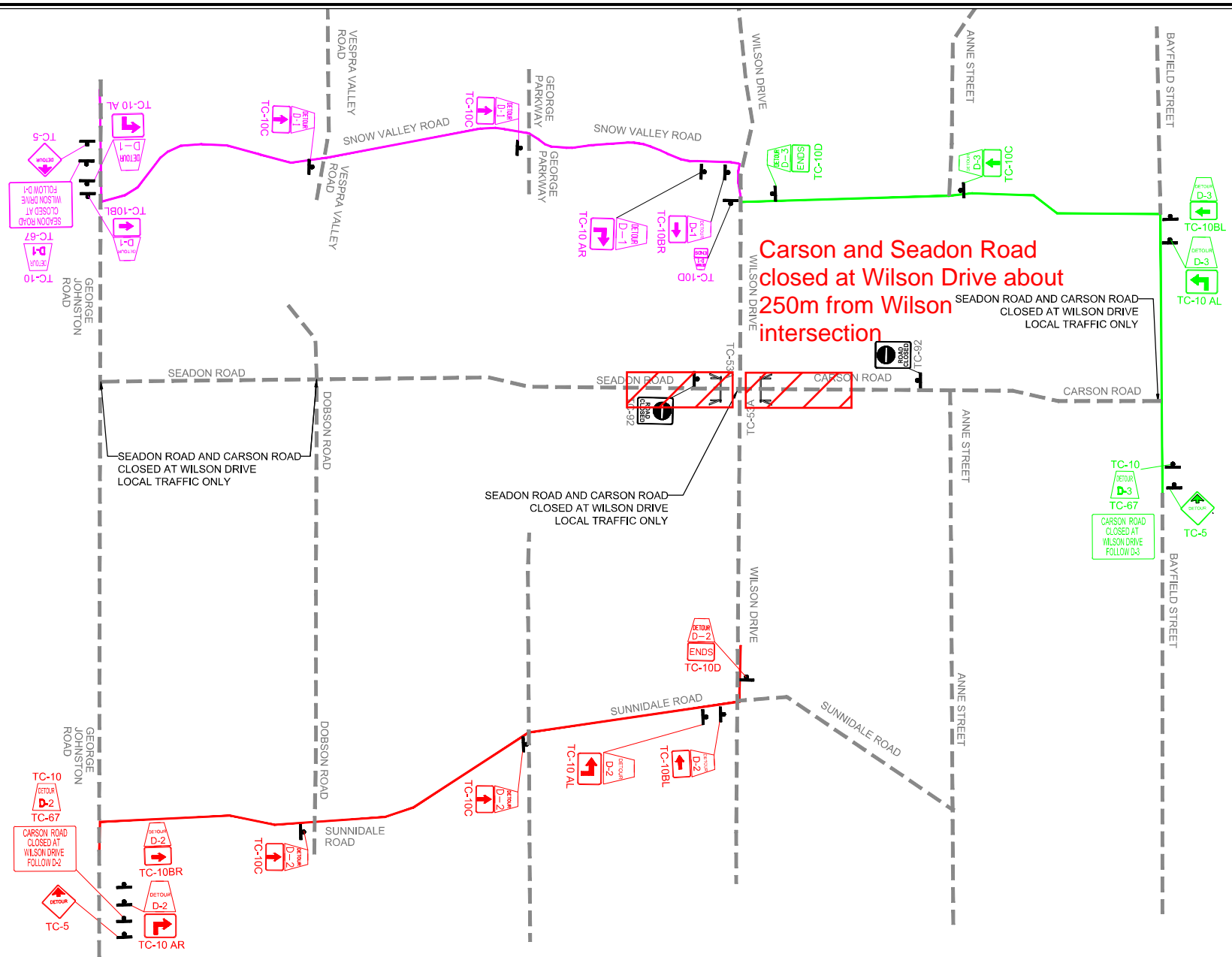

Carson and Seadon Road closed at Wilson Drive about 250m from Wilson intersection

SEADON ROAD AND CARSON ROAD CLOSED AT WILSON DRIVE LOCAL TRAFFIC ONLY

SEADON ROAD AND CARSON ROAD CLOSED AT WILSON DRIVE LOCAL TRAFFIC ONLY

SEADON ROAD AND CARSON ROAD CLOSED AT WILSON DRIVE LOCAL TRAFFIC ONLY

CARSON ROAD CLOSED AT WILSON DRIVE FOLLOW D-3

CARSON ROAD CLOSED AT WILSON DRIVE FOLLOW D-2

CONTRACT DRAWINGS

- ALL DIMENSIONS ARE IN METRES AND / OR MILLIMETRES UNLESS OTHERWISE INDICATED.
- DRAWINGS ARE NOT TO BE SCALED.
- THE EXACT LOCATION OF UTILITIES SHALL BE DETERMINED BY CONSULTING THE UTILITY COMPANIES CONCERNED. THE CONTRACTOR SHALL PROVE THE LOCATION OF UTILITIES AND SHALL BE RESPONSIBLE FOR ADEQUATE PROTECTION FROM DAMAGE.

BENCH MARK

BENCH-MARK NO. BM 1428. MONUMENT IS LOCATED ON THE NORTH SIDE R.O.W. LINE 50M WEST OF THE EXISTING SEADON ROAD / CARSON ROAD AND WILSON DRIVE INTERSECTION.

ELEVATION: 288.01m



No.	REVISIONS	Date	By	Appr.
2	ISSUED FOR TENDER	09-23-2022	JS	MF
1	ISSUED FOR 100% SUBMISSION	06-30-2022	JS	MF

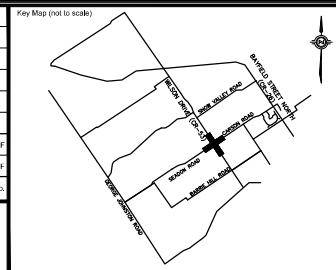

exp Services Inc.

E: +1.905.793.9800 | F: +1.905.793.0841
 1698 Oak Boulevard
 Brampton, ON L6T 4V1
 Canada
 www.exp.com

exp.

• BUILDINGS • EARTH & ENVIRONMENT • ENERGY •
 • INDUSTRIAL • INFRASTRUCTURE • SUSTAINABILITY •

COUNTY OF SIMCOE

SIMCOE COUNTY ROAD 53 & SEADON ROAD / CARSON ROAD INTERSECTION IMPROVEMENTS

DETOUR PLAN
 CARSON AND SEADON ROAD CLOSURE

Designed By: MF | Drawn By: JS | Checked By: CG
 Scale: N.T.S. | Date: JULY 2022 | Drawing No.:
 Project No.: DT-01

